

Autodesk Docs/30-22131-01 Liberty ESD Transportation Facility/30-22131-01\_Liberty ESD Transportation Site\_AR\_2022.rvt  
7/8/2024 11:23:46 PM

1

2

3

4

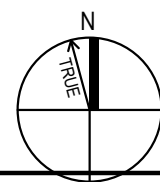
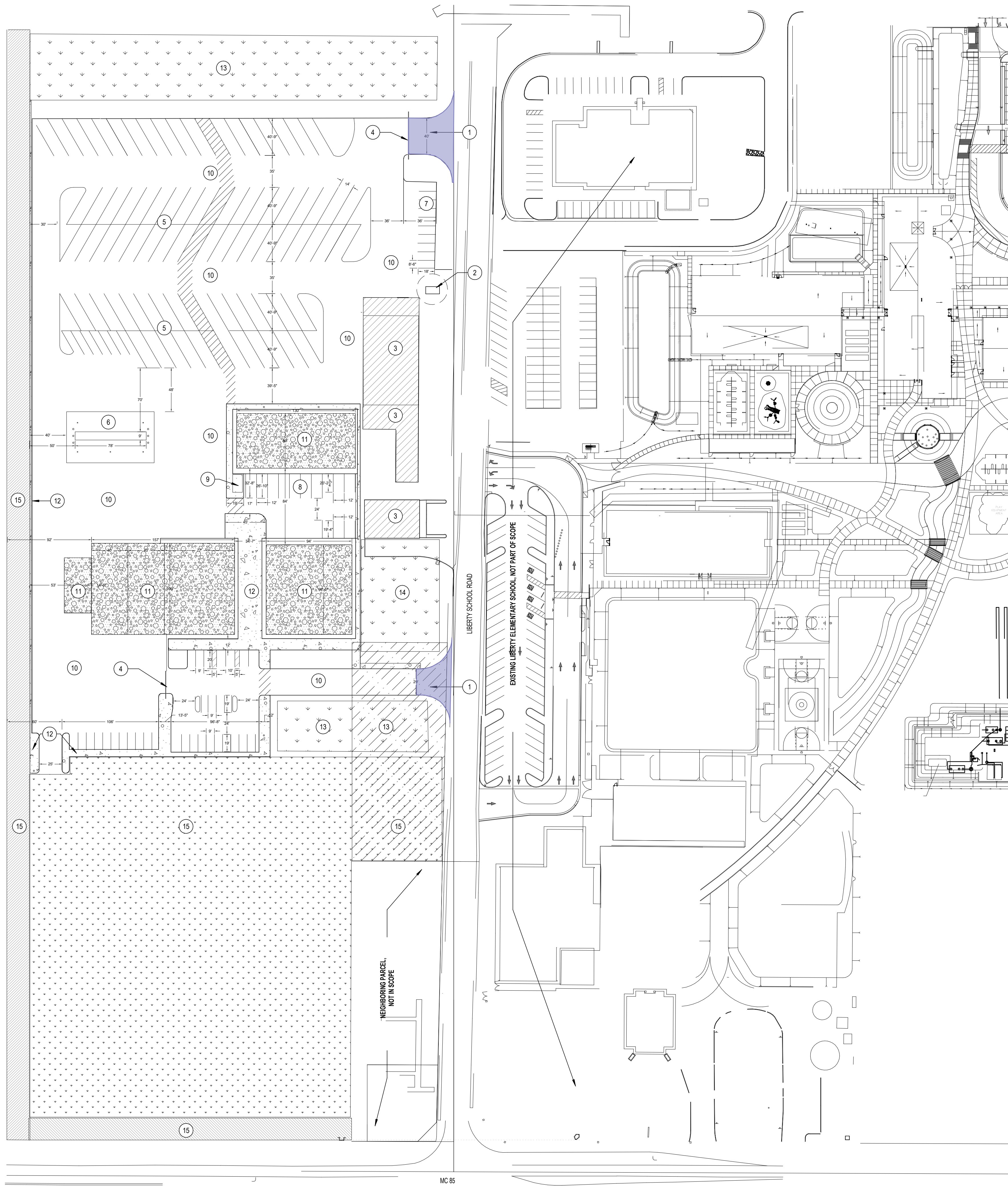

## Overall Site Plan

SCALE: 1" = 60'-0"

### SITE SYMBOLS

	PROPERTY LINE
	LOT LINE
	EASMENT LINE
	BUILDING LINE, EXISTING
	STREET CENTERLINE

### SITE LEGEND

	RETENTION AREA, SEE CIVIL
	EXISTING BUILDINGS TO REMAIN
	FUTURE BUILDING PAD LOCATION, SEE CIVIL
	CITY OF BUCKEYE, JURISDICTION

### # SHEET NOTES

- 1 DRIVEWAY & CURB CUT, SEE CIVIL
- 2 UNDERGROUND FUEL TANKS TO BE REMOVED THROUGH ADEQ'S TANK SITE REMOVAL PROGRAM.
- 3 EXISTING DISTRICT BUILDING TO REMAIN, NO WORK
- 4 ELECTRIC SLIDING METAL GATE, REFER TO CIVIL AND ELECTRICAL DRAWINGS.
- 5 BUS PARKING STRIPING, SEE CIVIL
- 6 ABOVE GROUND FUELING TANK AND CANOPY, SEE DEFERRED SUBMITTALS ON SHEET G0.1
- 7 VEHICLE PARKING, SEE CIVIL
- 8 WHITE FLEET PARKING, SEE CIVIL
- 9 ELECTRICAL SERVICE ENTRY, SEE ELECTRICAL
- 10 ASPHALT PAVING, SEE CIVIL
- 11 GRAVEL PAD, SEE CIVIL
- 12 CONCRETE SIDE CURB / SIDEWALK, SEE CIVIL
- 13 RETENTION, SEE CIVIL
- 14 SEPTIC, SEE DEFERRED SUBMITTALS ON SHEET G0.1
- 15 NO WORK THIS AREA



**Liberty Transportation Center**  
Liberty Elementary School District  
Liberty School Road and MC85

Construction Documents / Permit Set  
04.04.24  
REVISIONS  
AS1.01 07/01/24 MARICOPA CO. COMMENTS

30-22131-01  
ARCHITECTURAL SITE PLAN

AS1.1



LEGEND

BC	EXISTING BACK OF CURB ELEVATION
*875.41	EXISTING EDGE OF PAVEMENT ELEVATION
EP	
*875.09	
C	EXISTING CONCRETE ELEVATION
*875.12	
FL	EXISTING FLOWLINE ELEVATION
*875.01	
TB	EXISTING TOP OF BERM ELEVATION
*876.08	
TS	EXISTING TOE OF SLOPE ELEVATION
*875.14	
P	EXISTING PAVEMENT ELEVATION
*875.18	
NG	EXISTING GROUND ELEVATION
*874.82	
RBC	EXISTING ROLL CURB ELEVATION
*874.24	
FF	EXISTING FINISH FLOOR ELEVATION
*876.99	
SW	EXISTING SIDEWALK ELEVATION
*876.78	
HW	EXISTING HEADWALL ELEVATION
*878.38	
DG	DECOMPOSED GRANITE ELEVATION
*877.85	
WD	EXISTING WOOD STEP ELEVATION
*879.89	
LC	EXISTING LANDSCAPE CURB ELEVATION
*877.27	
UD	EXISTING UNDER DRAIN ELEVATION
*876.08	
RR	EXISTING RIP-RAP ELEVATION
*874.38	
DR	EXISTING DIRT ROAD ELEVATION
*877.04	
IMH	EXISTING IRRIGATION MANHOLE
SSMH	EXISTING SANITARY SEWER MANHOLE
SSCO	EXISTING SANITARY SEWER CLEANOUT
EC	EXISTING ELECTRIC CABINET
ET	EXISTING ELECTRIC TRANSFORMER
AC	EXISTING AIR CONDITIONING UNIT
RD	EXISTING ROOF DRAIN
ER	EXISTING ELECTRIC RISER
EBB	EXISTING ELECTRIC BREAKER BOX
	EXISTING PASTURE VALVE
ICV	EXISTING IRRIGATION CONTROL VALVE
PST	EXISTING POST
PB	EXISTING PIPE BOLLARD
CBOX	EXISTING CBOX
RP	EXISTING RISER PIPE
WR	EXISTING WATER RISER
GR	EXISTING GAS RISER
GM	EXISTING GAS METER
GI	EXISTING GREASE INTERCEPTER
DCV	EXISTING DOUBLE CHECK VALVE
BFP	EXISTING BACK FLOW PREVENTER
PP	EXISTING POWER POLE
IB	EXISTING I-BEAM
SIGN	EXISTING SIGN
BB	EXISTING BUMPER BLOCK
JB	EXISTING JUNCTION BOX
CB	EXISTING CATCH BASIN
FH	EXISTING FIRE HYDRANT
SDCO	EXISTING STORM DRAIN CLEANOUT
CR	EXISTING COMMUNICATION RISER
SS	EXISTING SAFETY SWITCH
DL	EXISTING DRIPLINE
CLM	EXISTING COLUMN
GW	EXISTING GUY WIRE
LPL	EXISTING LIGHT POLE
WMB	EXISTING WATER METER BOX
WV	EXISTING WATER VALVE
FDC	EXISTING FIRE DEPARTMENT CONNECTION
HB	EXISTING HOSE BIB
	EXISTING SHUTOFF VALVE
C=77.00	PROPOSED CONCRETE ELEVATION
G=75.37	PROPOSED GUTTER ELEVATION
F=75.31	PROPOSED FLOWLINE ELEVATION
TC=77.10	PROPOSED TOP OF CURB ELEVATION
P=76.60	PROPOSED PAVEMENT ELEVATION
G.B.	PROPOSED GRADE BREAK
S=0.3%	PROPOSED FLOW DIRECTION

GENERAL NOTES (MARICOPA COUNTY):

- ALL WORK SHALL CONFORM TO THE MOST CURRENT UNIFORM STANDARD SPECIFICATIONS FOR PUBLIC WORKS CONSTRUCTION PUBLISHED BY THE MARICOPA ASSOCIATION OF GOVERNMENTS (MAG), TOGETHER WITH THE MCDOT SUPPLEMENT TO THE MAG STANDARD SPECIFICATIONS AND THE PROJECT SPECIAL PROVISIONS. ALL WORK MUST ALSO COMPLY WITH RESOLUTION 2001-01 - MARICOPA COUNTY RESOLUTION FOR PERMITS TO WORK IN DEDICATED RIGHT-OF-WAY AND RESOLUTION 2001-02 MARICOPA COUNTY RESOLUTION FOR STREET IMPROVEMENTS, INSTALLATION OF UTILITIES AND TRAFFIC CONTROL. ANY EXCEPTIONS MUST RECEIVE EXPLICIT APPROVAL FROM MCDOT AND SHALL BE IDENTIFIED ON THE PLANS AS HAVING EXPLICIT APPROVAL FROM MCDOT.
- THE ENGINEERING DESIGNS ON THESE PLANS ARE ONLY APPROVED BY MCDOT IN CONCEPT AND NOT IN DETAIL. CONSTRUCTION QUANTITIES ON THESE PLANS ARE NOT VERIFIED BY MCDOT. APPROVAL OF THESE PLANS ARE FOR PERMIT PURPOSES ONLY AND SHALL NOT PREVENT MCDOT FROM REQUIRING CORRECTION OF ERRORS IN THE PLANS WHERE SUCH ERRORS ARE SUBSEQUENTLY FOUND TO BE IN VIOLATION OF ANY LAW, ORDINANCE, HEALTH, SAFETY, MCDOT ROADWAY DESIGN MANUAL, OR OTHER DESIGN ISSUES.
- AN APPROVED SET OF PLANS SHALL BE ON THE SITE DURING CONSTRUCTION AND AVAILABLE TO MCDOT AND OTHER INSPECTORS.
- ALL BOX CULVERTS CONSTRUCTED IN THE PUBLIC RIGHT-OF-WAY SHALL COMPLY WITH ARIZONA DEPARTMENT OF TRANSPORTATION (ADOT) LATEST DESIGN SPECIFICATIONS AND STANDARDS. MINIMUM CLEAR HEIGHT OF BOX CULVERT SHALL BE 4 FEET.
- CONTRACTOR TO OBTAIN NECESSARY MCDOT PERMITS PRIOR TO CONSTRUCTION WITHIN COUNTY RIGHT-OF-WAY, AND ALL NECESSARY PERMITS FROM LOCAL GOVERNMENTS FOR WORK WITHIN THEIR JURISDICTION.
- CONTRACTOR SHALL NOTIFY THE MCDOT INSPECTION DEPT. AT LEAST 24 HOURS IN ADVANCE OF ANY CONSTRUCTION AT (602) 506-8606.
- CONTRACTOR PERFORMING CONSTRUCTION OR EXCAVATING OPERATIONS IS RESPONSIBLE FOR LOCATING AND RELOCATING ALL UTILITIES IN CONFLICT OR WITHIN THE CLEAR ZONE, AT NO EXPENSE TO MARICOPA COUNTY. THE CONTRACTOR SHALL CONTACT "BLUE STAKE" AT (602) 263-1100 PRIOR TO BEGINNING CONSTRUCTION.
- THE CONTRACTOR IS RESPONSIBLE FOR OBTAINING ANY REQUIRED PERMITS FOR EARTH MOVING FROM MARICOPA COUNTY AIR QUALITY DEPARTMENT'S DUST COMPLIANCE DIVISION (602) 506-6010 PRIOR TO CONDUCTING EXCAVATION OPERATIONS. A COPY OF THE PERMIT AND DUST CONTROL PLAN SHALL BE SUBMITTED TO THE COUNTY ENGINEER PRIOR TO COMMENCEMENT OF ANY EARTHMOVING ACTIVITIES.
- PRIOR TO CONDUCTING EXCAVATION OPERATIONS, THE CONTRACTOR SHALL OBTAIN FROM THE ARIZONA STATE HISTORICAL PRESERVATION OFFICER (602) 542-4009, RECOMMENDATIONS REGARDING THE NEED FOR CULTURAL RESOURCES (ARCHAEOLOGICAL) CLEARANCE. ALL DISCOVERIES OF HUMAN REMAINS, CULTURAL ARTIFACTS, OR PALEONTOLOGICAL REMAINS SHALL BE REPORTED TO THE ARIZONA STATE MUSEUM AND MCDOT. UPON DISCOVERY, CONTRACTOR SHALL CEASE OPERATIONS IN THE VICINITY OF THE FIND AND PROTECT THE DISCOVERY AREA FROM FURTHER DISTURBANCE UNTIL THE FIND CAN BE PROFESSIONALLY INVESTIGATED BY THE ARIZONA STATE MUSEUM AND MCDOT.
- EXCEPT UNDER EMERGENCY CONDITIONS, ROADS SHALL NOT BE CLOSED FOR CONSTRUCTION ACTIVITY UNLESS PRIOR APPROVAL IS OBTAINED FROM THE MCDOT TRANSPORTATION DIRECTOR OR HIS REPRESENTATIVE.
- PRIOR TO MOVING OR DESTROYING PROTECTED NATIVE PLANT SPECIES, THE CONTRACTOR SHALL FILE A FORMAL NOTICE OF INTENT WITH THE ARIZONA DEPARTMENT OF AGRICULTURE NATIVE PLANTS (602) 542-6408.
- PRIOR TO INSTALLATION OF CURB, GUTTER, SIDEWALK, BASE COURSE AND WEARING SURFACE, SUBMIT SOIL TEST(S) OF SUB-GRADE AND REVISED PAVEMENT DESIGN/CALCULATIONS TO MCDOT FOR REVIEW AND APPROVAL. IF SUB-GRADE STABILIZATION IS REQUIRED, THE AREA STABILIZED SHALL BE FROM BACK OF SIDEWALK TO BACK OF SIDEWALK AND MATCH THE STABILIZATION DEPTH OF THE PAVEMENT STRUCTURE.
- ASPHALT MIX DESIGN SHALL BE SUBMITTED TO MCDOT A MINIMUM OF 48 HOURS PRIOR TO PLACING ANY ASPHALT COURSES. (TRENCH WORK EXCLUDED.) ALL PAVED TURNOUTS SHALL HAVE THE SAME ASPHALT AND BASE REQUIREMENTS AS THE ADJACENT ROADWAY UNLESS NOTED OTHERWISE.
- ALL COMPACTION AND BACKFILL WITHIN COUNTY RIGHT-OF-WAY SHALL CONFORM TO THE MCDOT SUPPLEMENT TO MAG SPECIFICATIONS. BACKFILL UNDER EXISTING PAVEMENT, CURB AND GUTTER OR WITHIN TWO FEET (2') OR LESS FROM THE EDGE OF PAVEMENT SHALL CONSIST OF ONE-HALF (1/2) SACK CLSM.
- ALL STRUCTURES, SUCH AS MANHOLES, VALVE BOX & COVERS, AND MONITORING WELLS MUST BE MARKED WITH AT LEAST TWO REFLECTIVE YELLOW FLEX POSTS WHEN STRUCTURES ARE LOCATED OUTSIDE THE TRAVELED WAY AND WITHIN THE RIGHT-OF-WAY, (APPLIES ONLY WHEN THERE IS NO CURB.)
- ANY SAW CUT ALONG EXISTING ROADWAY EDGE WHICH REMOVES THE EDGE OF THE ROADWAY SHALL BE A MINIMUM OF 1' FROM THE EDGE OF THE EXISTING ROADWAY. THE CUT DISTANCE MAY BE GREATER, BASED ON PAVEMENT CONDITIONS OR ROADWAY ELEVATIONS BUT SHALL NOT BE LOCATED WITHIN A LANE WHEEL PATH, AND IF NEEDED SHALL BE IN HALF LANE INCREMENTS.
- ALL EXISTING PAVEMENT MARKING, TRAFFIC SIGNS AND SIGNAL EQUIPMENT THAT NEEDS TO BE REMOVED, REPLACED, RELOCATED OR REPAIRED BECAUSE OF CONTRACTOR'S WORK WILL BE DONE BY THE CONTRACTOR AT HIS EXPENSE. ALL SALVAGED SIGNS SHALL BE DELIVERED TO THE TRAFFIC OPS BUILDING AT 2909 W. DURANGO ST. ANAGEMENTS CAN BE MADE FOR DELIVERY BY CALLING (602) 506-8662. ALL NEW STREET NAME SIGNS SHALL BE PROVIDED AND INSTALLED BY PERMITTEE AT NO EXPENSE TO MARICOPA COUNTY.
- PAVEMENT MARKING, SIGNING AND SIGNAL WORK WILL BE INSPECTED AND SHALL MEET COUNTY STANDARDS BEFORE RELEASE OF BOND.
- THE CONTRACTOR SHALL RESTORE ALL DISTURBED AREAS WITHIN THE RIGHT-OF-WAY TO A CONDITION EQUAL TO OR BETTER THAN EXISTING IMPROVEMENTS PER MAG 107.9. DISPOSAL OF ALL WASTE MATERIAL WILL BE THE RESPONSIBILITY OF THE CONTRACTOR.

	PROPOSED CONCRETE SIDEWALK
	PROPOSED A.C. PAVEMENT (4" A.C. (3/4") OVER 7" A.B.C. OVER COMPACTED SUBGRADE

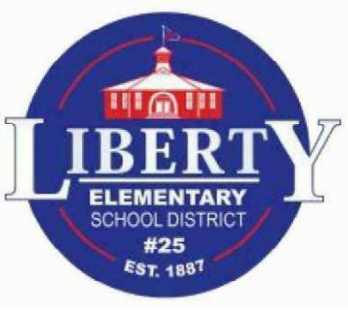
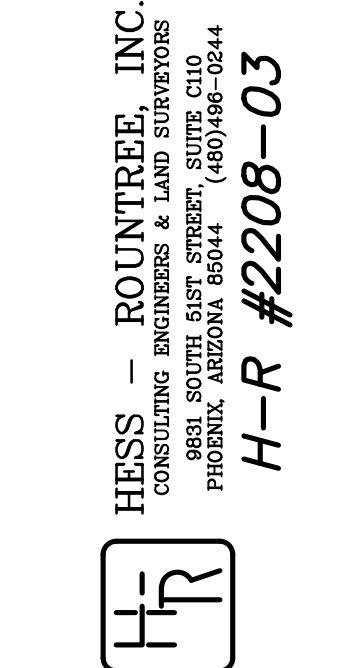
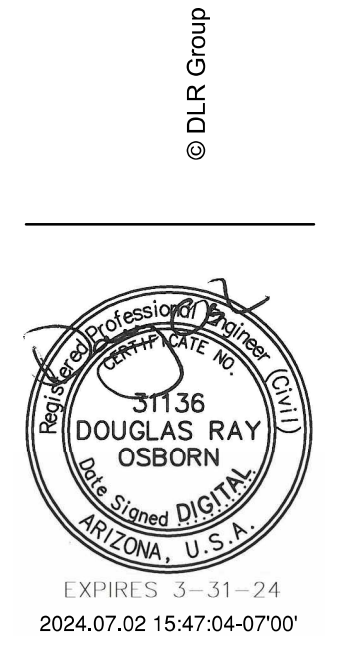
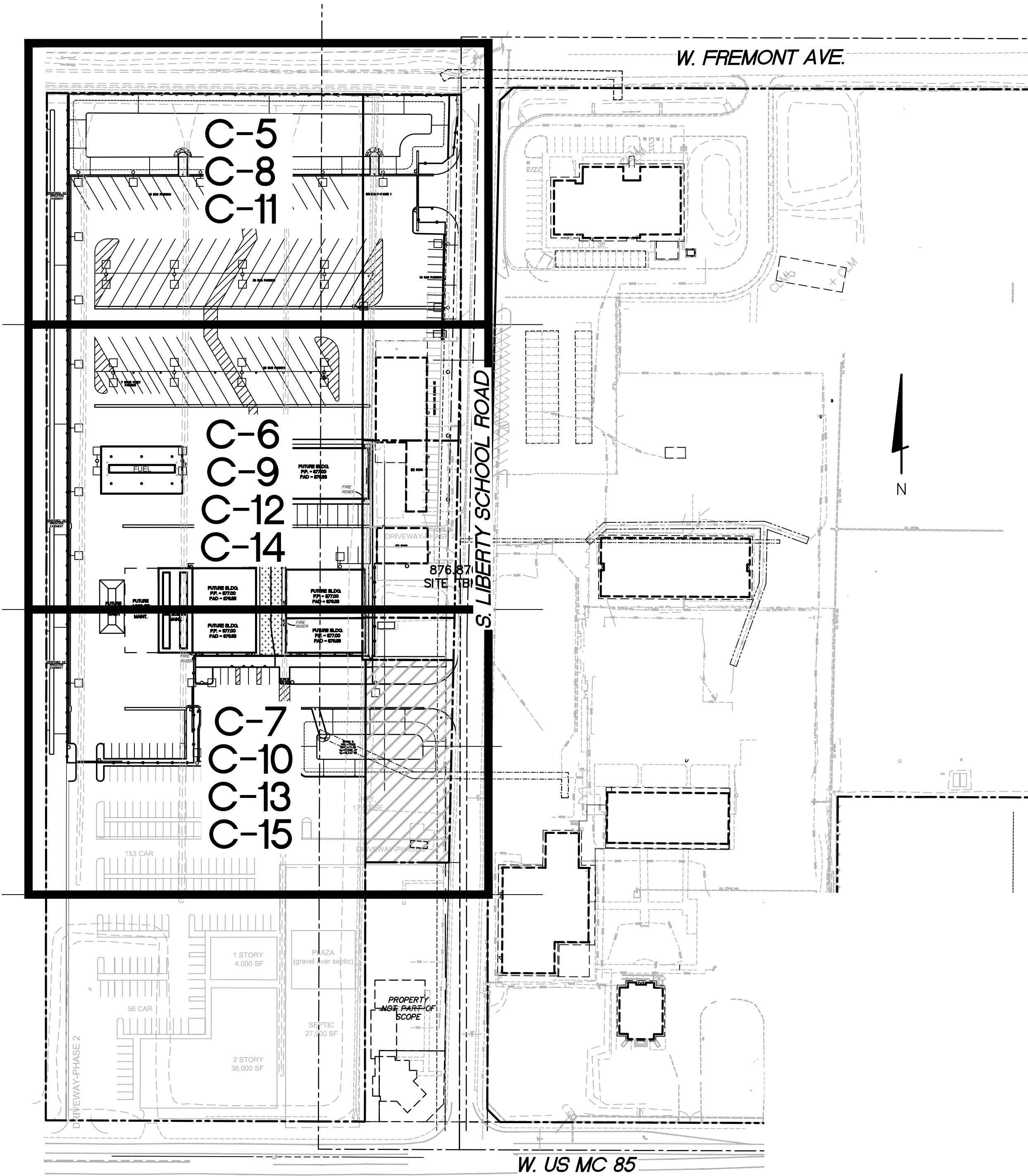

Liberty Transportation Center

Permit/GMP Documents  
07.02.24  
REVISIONS  
ASI 01 07/01/24 MARICOPA CO COMMENTS

30-22131-01  
NOTES, LEGEND AND KEYMAP SHEET





GRADING AND DRAINAGE CONSTRUCTION NOTES:

- 1

INSTALL A.C. PAVEMENT (3" A.C. (1/2 INCH) OVER 8" A.B.C. OVER COMPACTED SUBGRADE).
- 2

INSTALL CONCRETE SINGLE CURB (MAG STANDARD DETAIL NO. 222, TYPE 'A').
- 3

INSTALL CONCRETE VERTICAL CURB AND GUTTER (MAG STANDARD DETAIL NO. 220-1, TYPE A).
- 4

INSTALL CONCRETE SIDEWALK (MAG STANDARD DETAIL NO. 230). SEE LANDSCAPE DRAWINGS FOR SCORING AND FINISH.
- 5

DECOMPOSED GRANITE AT SIDEWALKS WITHIN 10' OF THE BUILDING SHALL BE FLUSH WITH THE SIDEWALK TO PREVENT WATER FROM PONDING WITH 10' OF THE BUILDING.
- 6

PAINT STRIPE PARKING LOT TO THE ALIGNMENTS INDICATED INCLUDING ALL DIRECTIONAL ARROWS, CROSSWALKS, HANDICAP PARKING SYMBOLS, ETC.
- 7

CONSTRUCT CONCRETE VALLEY GUTTER (MAG STANDARD DETAIL NO. 240, MODIFIED TO BE 3" WIDE).
- 8

SITE FENCING AND GATES. SEE LANDSCAPE DRAWINGS FOR DETAILS.
- 9

INSTALL CONCRETE SPLASHPAD (SEE DETAIL SHEET C-3).
- 10

INSTALL PIPE BOLLARD (MAG STANDARD DETAIL NO. 140, TYPE I).
- 11

INSTALL SIDEWALK RAMP TYPE A (SEE DETAIL ON SHEET C-3).
- 12

STRAIGHT GRADE PLANTERS TO HAVE FINISH GRADE 1" BELOW TOP OF CURB (TYPICAL).
- 13

INSTALL THICKENED PAVEMENT EDGE (MAG STANDARD DETAIL NO. 201, B).
- 14

INSTALL HANDICAP PARKING SIGN PER CITY OF BUCKEYE AND ADA REQUIREMENTS. POST AND BASE PER MAG STANDARD DETAIL NO. 131, TYPE 'C'. TOP OF SIGN SHALL BE 6' ABOVE GRADE. TYPICAL AT EACH HANDICAP SPACE.
- 15

INSTALL CURB TERMINATION (MAG STANDARD DETAIL NO. 222, MODIFIED FOR CONCRETE CURB AND GUTTER WHERE INDICATED).
- 16

MATCH EXISTING GRADE.
- 17

STRAIGHT GRADE FROM 2" BELOW TOP OF CURB AT A MAXIMUM OF 5:1 SLOPE TO MATCH INTO EXISTING GRADE.

- 18

STRAIGHT GRADE FROM 6" BELOW TOP OF CURB AT A MAXIMUM OF 5:1 SLOPE TO MATCH INTO EXISTING GRADE.
- 19

STABILIZED DECOMPOSED GRANITE (SEE LANDSCAPE PLANS FOR DETAILS).
- 20

FUEL STATION BY OTHERS.
- 21

PROTECT EXISTING PAVEMENT EDGE. ANY SAWCUT PAVEMENT SHALL BE TRIMMED TO A CLEAN EDGE, BUT ANY THICKENED EDGE SHALL NOT BE REMOVED.
- 22

CONSTRUCT PAVED TURNOUT (PER MAG STANDARD DETAIL NO. 205, TYPE A).
- 23

INSTALL A.C. PAVEMENT (2" A.C. (1/2 INCH) OVER 8" A.B.C. OVER COMPACTED SUBGRADE)

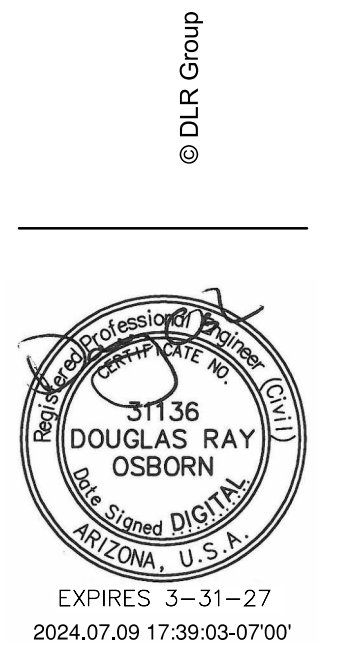
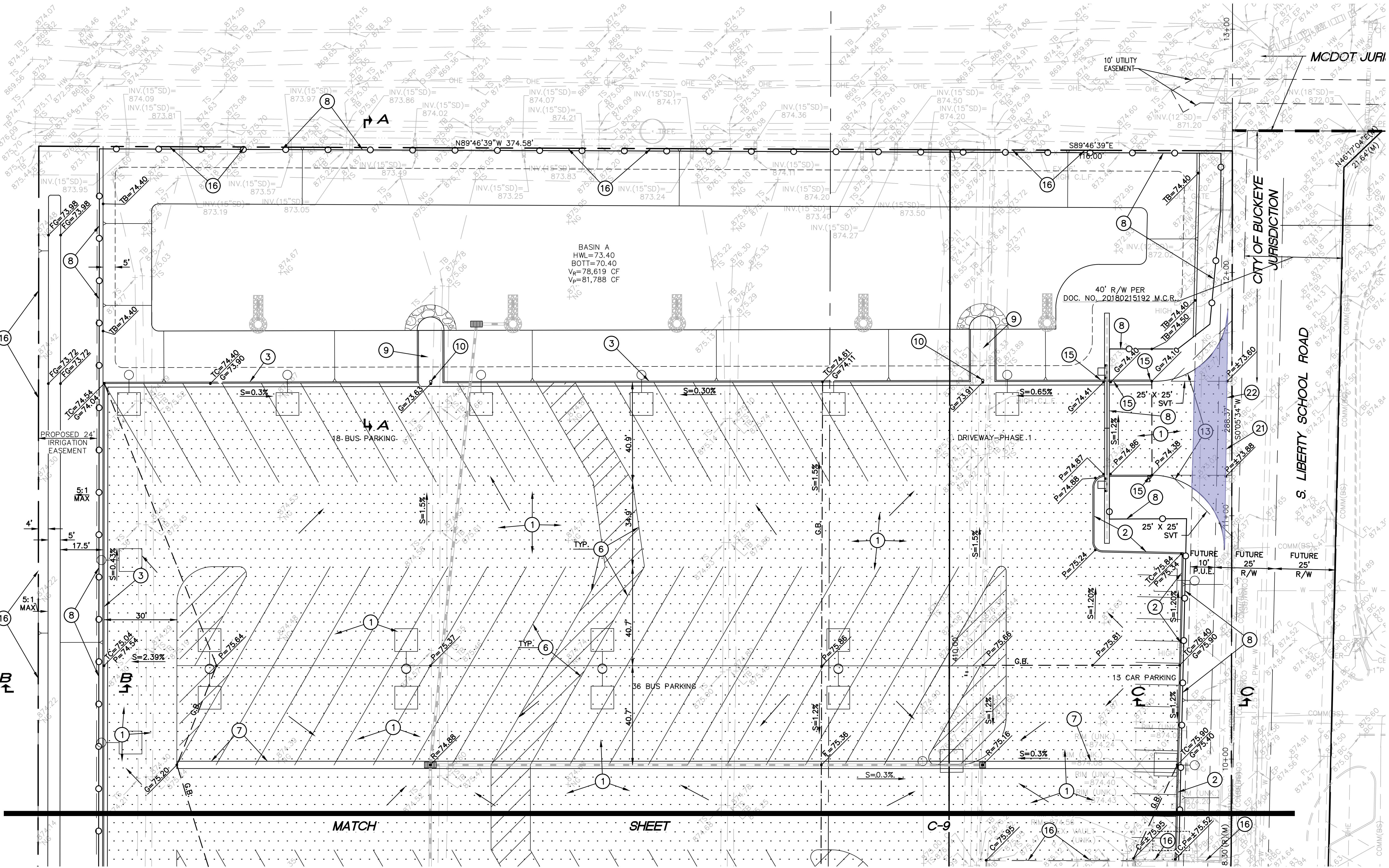

HPSS - ROUNTREE, INC.  
CONSULTING ENGINEERS & LAND SURVEYORS  
9831 SOUTH 61ST STREET, SUITE C10  
PHOENIX, ARIZONA 85044  
H-R #2208-03

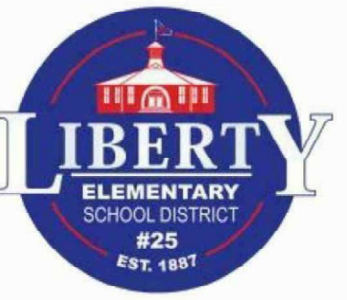
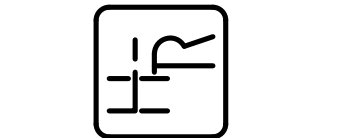

Liberty Transportation Center

Permit/GMP Documents  
07.02.24  
REVISIONS  
ASI 01 07/01/24 MARICOPA CO. COMMENTS

30-22131-01  
GRADING AND DRAINAGE PLAN





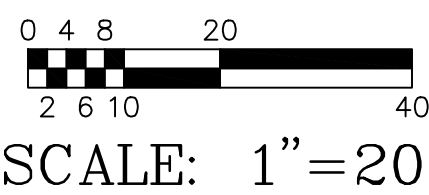

- (1) INSTALL A.C. PAVEMENT (3" A.C. (1/2 INCH) OVER 8" A.B.C. OVER COMPACTED SUBGRADE).
- (2) INSTALL CONCRETE SINGLE CURB (MAG STANDARD DETAIL NO. 222, TYPE 'A').
- (3) INSTALL CONCRETE VERTICAL CURB AND GUTTER (MAG STANDARD DETAIL NO. 220-1, TYPE A).
- (4) INSTALL CONCRETE SIDEWALK (MAG STANDARD DETAIL NO. 230). SEE LANDSCAPE DRAWINGS FOR SCORING AND FINISH.
- (5) DECOMPOSED GRANITE AT SIDEWALKS WITHIN 10' OF THE BUILDING SHALL BE FLUSH WITH THE SIDEWALK TO PREVENT WATER FROM PONDING WITH 10' OF THE BUILDING.
- (6) PAINT STRIPE PARKING LOT TO THE ALIGNMENTS INDICATED INCLUDING ALL DIRECTIONAL ARROWS, CROSSWALKS, HANDICAP PARKING SYMBOLS, ETC.
- (7) CONSTRUCT CONCRETE VALLEY GUTTER (MAG STANDARD DETAIL NO. 240, MODIFIED TO BE 3' WIDE).
- (8) SITE FENCING AND GATES. SEE LANDSCAPE DRAWINGS FOR DETAILS.
- (9) INSTALL CONCRETE SPLASHPAD (SEE DETAIL SHEET C-3).
- (10) INSTALL PIPE BOLLARD (MAG STANDARD DETAIL NO. 140, TYPE I).
- (11) INSTALL SIDEWALK RAMP TYPE A (SEE DETAIL ON SHEET C-3).
- (12) STRAIGHT GRADE PLANTERS TO HAVE FINISH GRADE 1" BELOW TOP OF CURB (TYPICAL).
- (13) INSTALL THICKENED PAVEMENT EDGE (MAG STANDARD DETAIL NO. 201, B).
- (14) INSTALL HANDICAP PARKING SIGN PER CITY OF BUCKEYE AND ADA REQUIREMENTS. POST AND BASE PER MAG STANDARD DETAIL NO. 131, TYPE 'C'. TOP OF SIGN SHALL BE 6' ABOVE GRADE. TYPICAL AT EACH HANDICAP SPACE.
- (15) INSTALL CURB TERMINATION (MAG STANDARD DETAIL NO. 222, MODIFIED FOR CONCRETE CURB AND GUTTER WHERE INDICATED).
- (16) MATCH EXISTING GRADE.
- (17) STRAIGHT GRADE FROM 2" BELOW TOP OF CURB AT A MAXIMUM OF 5:1 SLOPE TO MATCH INTO EXISTING GRADE.
- (18) STRAIGHT GRADE FROM 6" BELOW TOP OF CURB AT A MAXIMUM OF 5:1 SLOPE TO MATCH INTO EXISTING GRADE.
- (19) STABILIZED DECOMPOSED GRANITE (SEE LANDSCAPE PLANS FOR DETAILS).
- (20) FUEL STATION BY OTHERS.
- (21) PROTECT EXISTING PAVEMENT EDGE. ANY SAWCUT PAVEMENT SHALL BE TRIMMED TO A CLEAN EDGE, BUT ANY THICKENED EDGE SHALL NOT BE REMOVED.
- (22) CONSTRUCT PAVED TURNOUT (PER MAG STANDARD DETAIL NO. 205, TYPE A).
- (23) INSTALL A.C. PAVEMENT (2" A.C. (1/2 INCH) OVER 8" A.B.C. OVER COMPACTED SUBGRADE)



10 OF 17  
C-10



Autodesk Docs:\30-22131-01 Liberty ESD Transportation Facility\30-22131-01\_Liberty ESD Transportation Site\_AR\_2022.rvt  
1/30/2024 11:27:35 AM

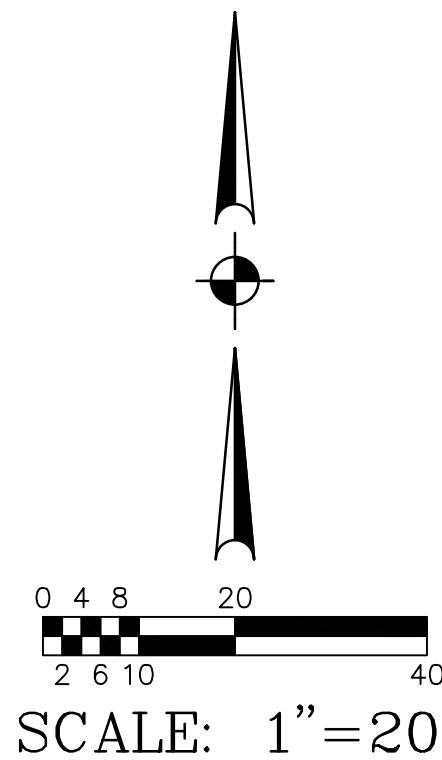
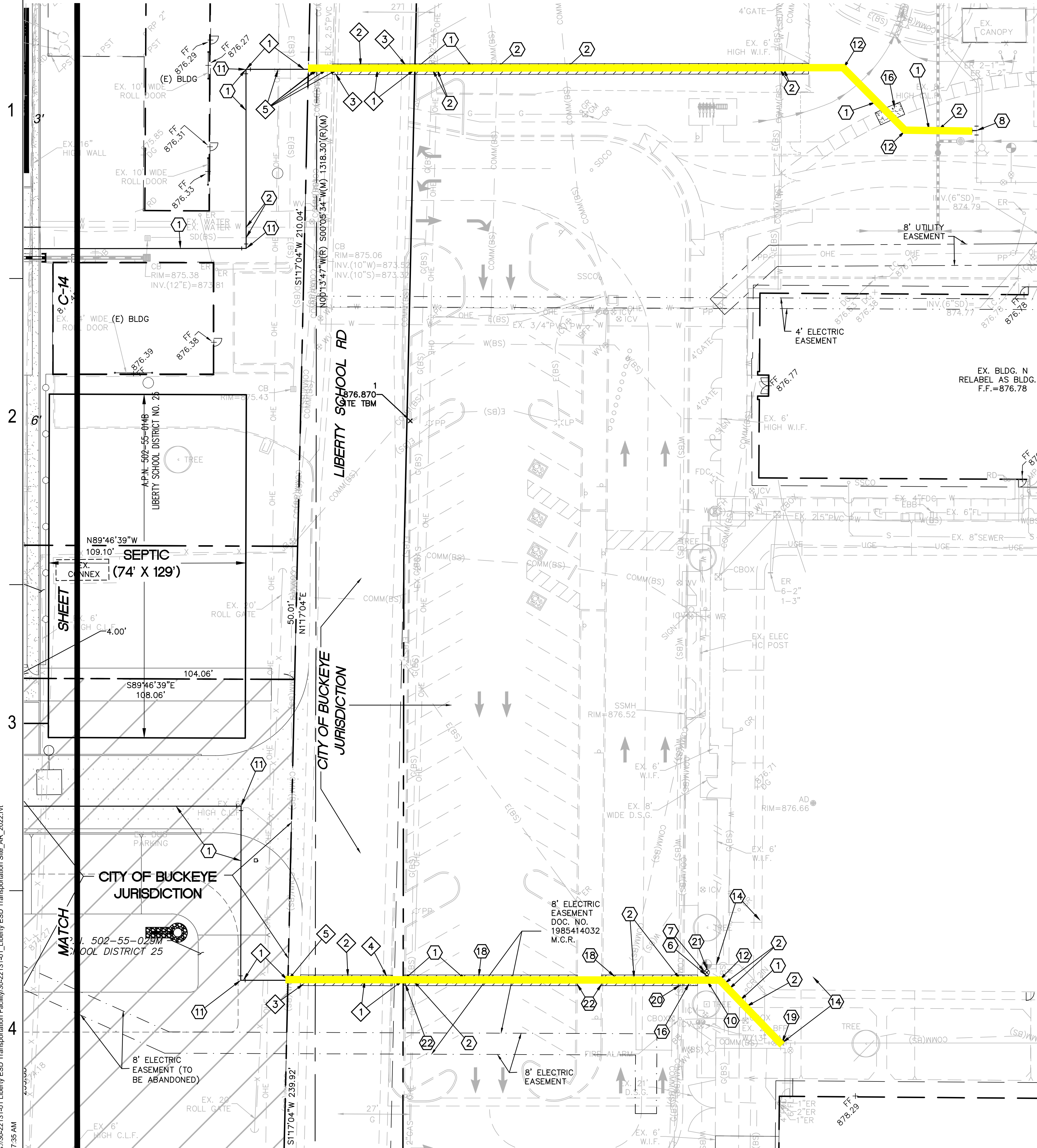

© DLR Group

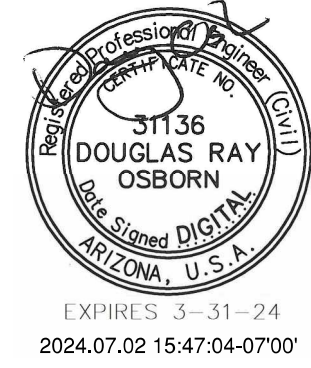

HPSS - ROUNDTREE, INC.  
CONSULTING ENGINEERS & LAND SURVEYORS  
9831 SOUTH 51ST STREET, SUITE C10  
PHOENIX, ARIZONA 85044 (480)68-0244  
H-R #2208-03

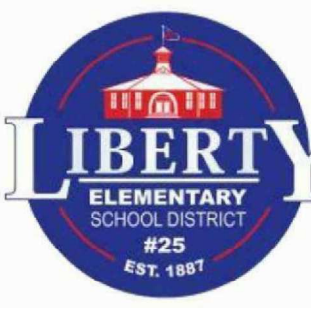
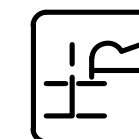

Liberty Transportation Center

Permit/GMP Documents  
07.02.24  
REVISIONS  
ASI 01 07/01/24 MARICOPA CO COMMENTS

30-22131-01

